

GENOTROPIN GOQUICK®

INSTRUCTIONS FOR USE

Important Information

Please read these instructions completely before using GoQuick. If you have any questions about your dose or your treatment with Genotropin, call your doctor or nurse.

About GoQuick

GoQuick is a pre-filled, multidose, disposable injection pen that holds 5.0 mg of somatropin. The Genotropin in the pen is mixed only once, when you start a new pen. A single pen can be used up to 28 days after mixing. You never have to change cartridges. When the pen is empty, you just start a new pen.

The pen has dose memory. The dose is set once on a new pen. The pen then gives the same dose for each injection. You can use the pen with or without the optional needle guard.

Before You Use GoQuick

- Get training from your doctor or nurse.
- Know your dose. Know the pen parts.
- Make sure you have the pen with the green injection button.
- Wash your hands.

For Your Injection You Will Need

- 31G 5/8 mm, or 32G 4 mm Becton Dickinson pen needle, or
- 32.5G 4/6/8 mm, or 34G 4 mm Terumo Nanopass pen needle
- Proper disposal container for used needles.

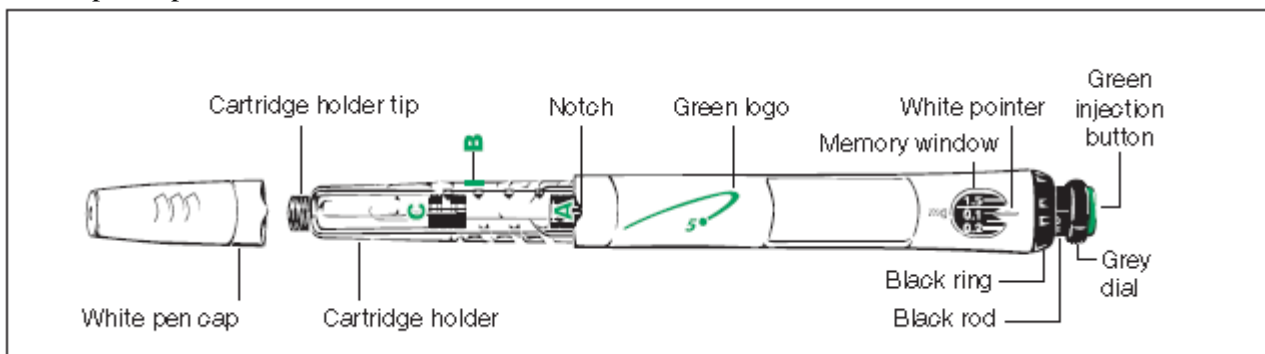

Needle (not included)

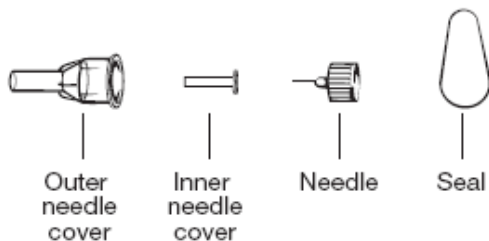

Needle Guard (not included) with needle shield released

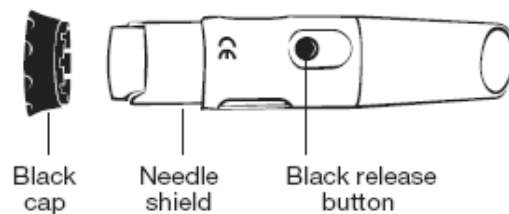

Setting Up and Using a New GoQuick

Step 1. Attach the Needle

- a. Pull the white pen cap straight off the pen.
- b. Peel the seal from a new needle.
- c. Firmly grasp the cartridge holder. (Figure 1)
- d. Push the needle onto the cartridge holder tip.
- e. Gently screw the needle onto the pen. Do not overtighten.
- f. Leave both needle covers on the needle.

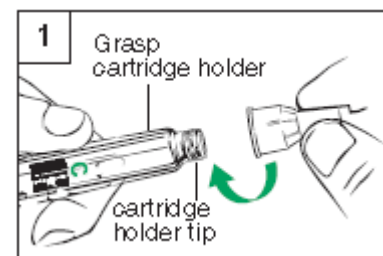

Step 2. Mix the Genotropin

- Hold the pen with the needle-end pointing up and the **A** facing you. (Figure 2)
- Firmly** twist the cartridge holder into the pen until **B** clicks into the notch.
 - Gently tilt the pen from side to side. Do not shake the pen. Shaking may damage the growth hormone.
- Check that the liquid in the cartridge is clear. All the powder should be dissolved.
 - If not, gently tilt the pen from side to side a few more times.
- Check the liquid again. Make sure it is clear.
 - If the liquid is clear, go to Step 3.
 - If the liquid is still cloudy or you see any powder, use a new pen.

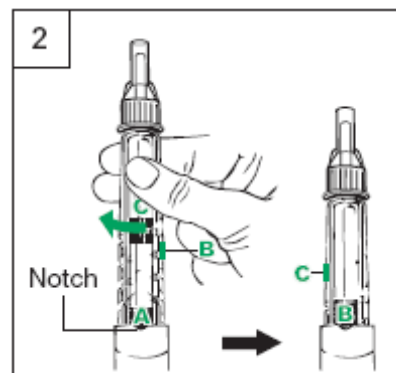

Step 3. Remove the Air

- Pull the outer needle cover off. Save it to re-cap and remove the needle. (Figure 3a)
 - Leave the inner needle cover on.
- Hold the pen with the needle-end pointing up. (Figure 3b)
 - Tap the cartridge holder gently to help any trapped air move to the top.
 - Firmly**, twist the cartridge holder into the pen until **C** clicks into the notch.
 - Some liquid may appear around the inner needle cover.

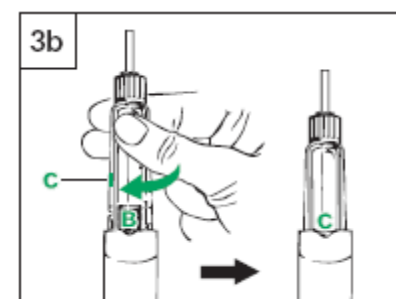
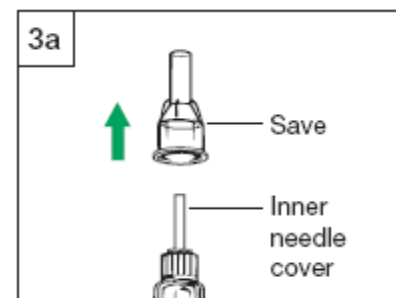

Step 4. Attach the Needle Guard (Optional)

- Pull the black cap off the needle guard. (Figure 4a)
 - If the needle shield slides out, push it back into the needle guard until it clicks into place.
- Hold the pen in one hand below the green logo. With the other hand, hold the needle guard below the needle shield. (Figure 4b)
 - Line up the black logo on the needle guard with the green logo on the pen. Carefully push the needle guard onto the pen until it snaps into place.

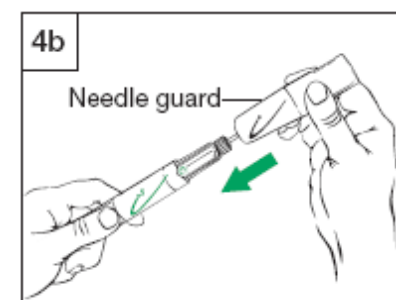
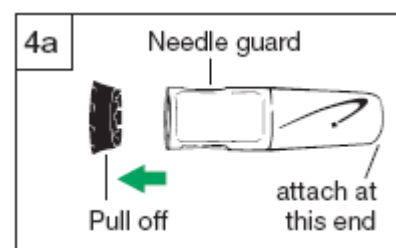

Step 5. Prime the Pen

- a. Pull the inner needle cover off. Throw it away. (Figure 5a)

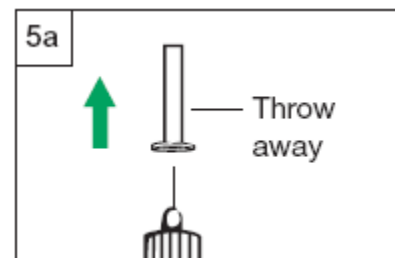

- b. Check that 0.1 mg is set in the memory window.
- c. Turn the grey dial in the direction of the arrows until it stops clicking. (Figure 5b)

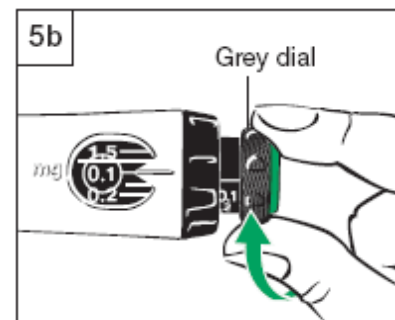

- d. Hold the pen with the needle pointing up. (Figure 5c with and without needle guard)
- e. Push the green injection button until liquid appears.
- f. If liquid does not appear at Step “e”, repeat Steps b-e in this section up to two more times.
- g. If liquid still does not appear, do not use the pen.
 - See the Questions and Answers section below for more information.

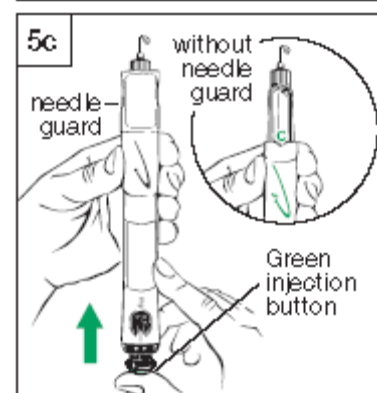

- h. If you use the needle guard, press the black button to release the needle shield. (Figure 5d)

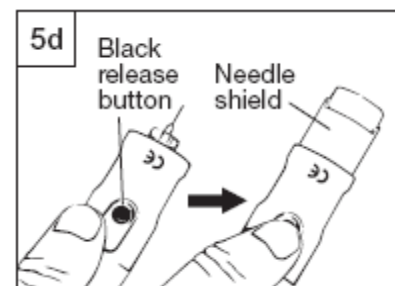

Step 6. Set the Dose

- Use the black ring to set the dose. Be careful not to turn the grey dial while setting the dose.
- a. Hold the black ring as shown in Figure 6.
 - b. Turn the black ring until your dose lines up with the white pointer. Your doctor or nurse has told you your dose.
 - c. If you turn your dose past the white pointer, just turn the black ring back to set the correct dose.
 - d. Once you have set your dose, do not change it unless your doctor or nurse tells you.

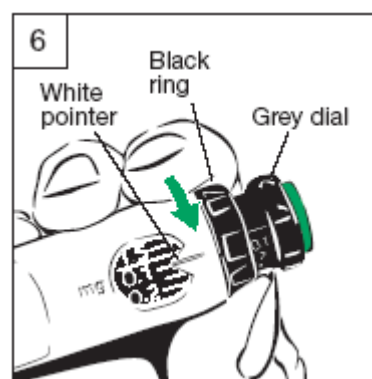

Note: If you cannot turn the black ring, press in the green injection button until it stops clicking. Then continue to set your dose using the black ring (for more information, see also the Questions and Answers section below).

Step 7. Draw Up a Dose

- Turn the grey dial in the direction of the arrow until the clicking stops. (Figure 7a)
- Your dose on the black rod should line up with the white pointer.

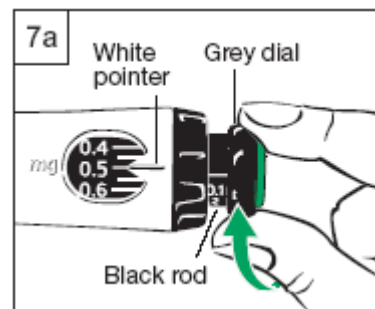

- Check that the dose you drew up on the black rod is the same as the dose you set in the memory window. Figure 7b shows an example.
- If the doses do not match, make sure you have turned the grey dial in the direction of the arrow until it does not click anymore.

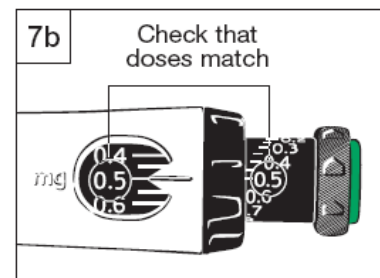

Step 8. Give the Injection

- Prepare an injection site as your doctor or nurse has told you.
- Hold the pen over the injection site.
- Push the pen down to insert the needle into the skin.
- Using your thumb, push the green injection button down until it stops clicking. (Figure 8)
 - Count for 5 seconds before you pull the needle out of the skin. Keep light pressure on the button with your thumb while you count.
- Pull the pen straight out from the skin.

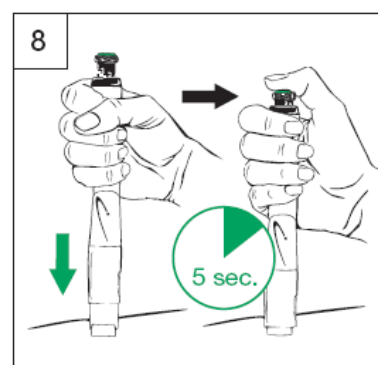

Step 9. Remove the Needle; Cap and Store Your Pen

Step 9a: With needle guard

- Place the outer needle cover into the end of the needle shield. (Figure 9a)
- Use the needle cover to push in the needle shield until it locks into place.
- Use the needle cover to unscrew the needle and put it in a proper container for used needles.
- Leave the needle guard on the pen.
- Place the black cap on the needle guard. Store your pen in the refrigerator.

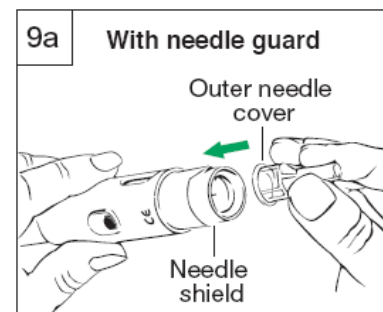

Step 9b: Without needle guard

- Do not touch the needle.
- Carefully cover the needle with the outer needle cover. (Figure 9b)
- Use the needle cover to unscrew the needle and put it in a proper container for used needles.
- Place the white cap on the pen. Store your pen in the refrigerator.

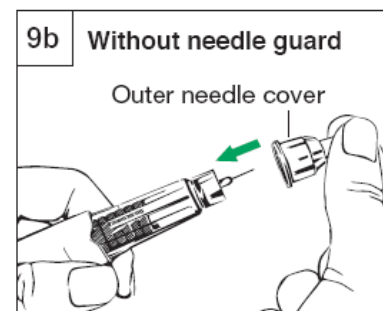

Routine Use of GoQuick

1. Pull the black cap from the needle guard or the white cap from the pen.

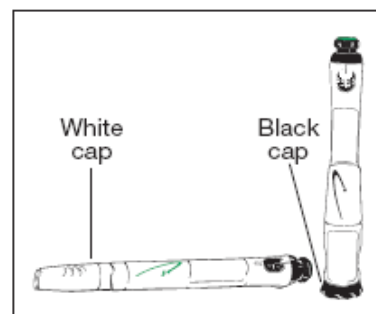

2. Attach a new needle.
 - With the needle guard:
 - If the needle shield releases, push it back into place.
 - Attach a new needle to the cartridge holder tip.

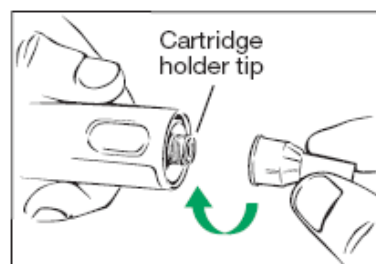

- Without the needle guard:
 - Attach a new needle to the cartridge holder tip.

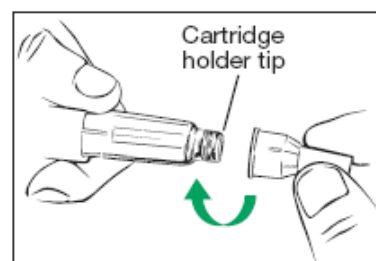

3. Remove both needle covers. Save the outer needle cover to re-cap and remove the needle.

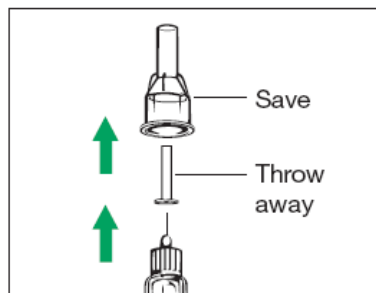

4. If you use the needle guard, press the black release button to extend the needle shield.

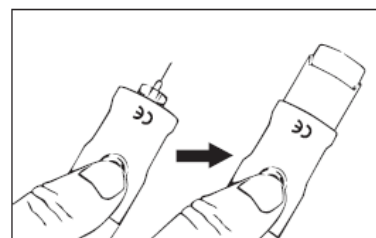

5. To draw up the dose, turn the grey dial until it stops clicking.

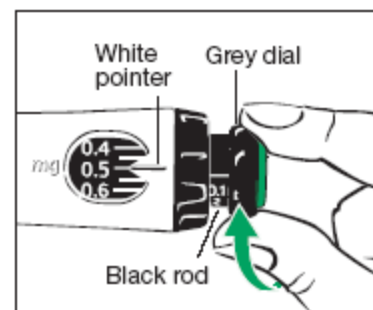

6. Check that the dose you drew up is the same as the dose you set in the memory window.
 - If the dose you drew up is smaller, the pen does not have a full dose of Genotropin.
 - Follow what your doctor or nurse told you to do when the pen does not have a full dose left.

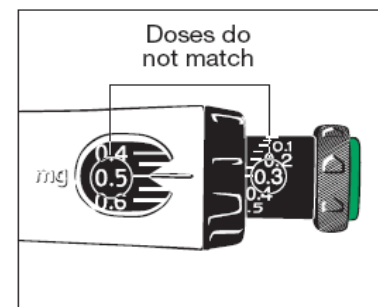

7. Prepare an injection site as your doctor or nurse has told you.
8. Give the injection.
 - Push the pen down to insert the needle into the skin.
 - Push the green injection button down until it stops clicking.
 - Count for 5 seconds before you pull the needle out of the skin. Keep light pressure on the button with your thumb while you count.
 - Pull the pen straight out from the skin.

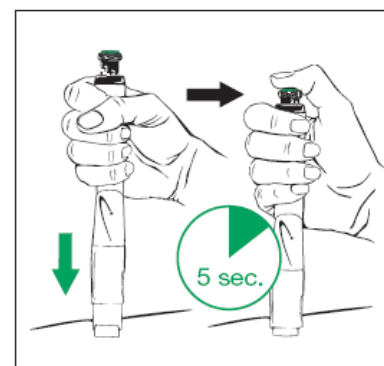

9. Remove the needle.
 - With the needle guard
 - Use the outer needle cover to push in the needle shield until it locks into place.
 - Without the needle guard
 - Carefully cover the needle with the outer needle cover.
 - Use the outer needle cover to unscrew the needle. Throw the needle away in a proper container for used needles.

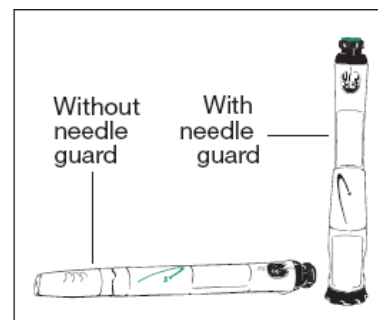

10. Cap your needle guard or pen and store it in the refrigerator.

ADDITIONAL INFORMATION

Storage

- See the other side of this leaflet for how to store your GoQuick.
- After 4 weeks, dispose of the pen (or discard) even if there is some medicine left.
- Do not freeze or expose GoQuick to frost.
- Do not use your GoQuick after its expiry date.
- Follow your local health and safety laws to dispose of (or discard) your pen. Ask your doctor or nurse if you are not sure what to do.

Handling

- Do not mix the powder and liquid of GoQuick unless a needle is on the pen.

- Do not store your GoQuick with the needle attached. The Genotropin may leak from the pen and air bubbles may form in the cartridge. Always remove the needle and attach the pen cap or needle guard cap before storing.
- Take care not to drop your GoQuick.
- If you do drop the pen you must perform another prime as described in Step 5 (Setting Up and Using a New GoQuick). But if any part of your GoQuick appears broken or damaged, do not use the pen. Contact your doctor or nurse for another pen.
- Clean the pen and needle guard with a damp cloth. Do not put the pen in water.

Needles

- Always use a new needle for each injection.
- Put all used needles in an appropriate “sharps” container. Follow your local health and safety laws to dispose of your needles. Ask your doctor or nurse if you are not sure what to do.
- Do not share your pen or needles.

General

- The numbers and lines on the cartridge holder can help you estimate how much Genotropin is left in the pen.
- If in routine use Step 6 the pen does not have a full dose of Genotropin, the scale on the black rod indicates the amount of drug remaining in the pen.
- Patients who are blind or who do not see well should only use GoQuick with the help of someone trained to use the pen.
- Follow your doctor or nurse’s instructions for cleaning your hands and skin when you prepare and give the injection.
- Do not discard your needle guard, to remove it from the pen just twist it off. Save it to use with each new pen.
- If you have questions about how to use GoQuick, ask your doctor or nurse.

QUESTIONS AND ANSWERS

Question

What should I do if I see more than a small drop of liquid on the needle after giving my injection?

Is it a problem if I see air bubbles in the cartridge?

What should I do if I see Genotropin leaking from the pen?

What should I do if the pen that I am using was not put into the refrigerator overnight?

What should I do if I can’t turn the black ring?

What if my doctor changes my dose when I’ve already started a pen?

What if I inject the wrong dose?

What if my pen will not prime (i.e. if liquid did not appear in step 5g)?

What doses can my pen deliver?

Answer

For your next injection wait the full time of 5 seconds before taking the needle from the skin. If you still see some liquid after you take out the needle, hold in for a little longer next time.

No, small amounts of air may be present in the cartridge during normal use.

Make sure that the needle has been attached correctly.

Discard the pen and use a new GoQuick.

You have probably accidentally turned the grey dial. If you have turned the grey dial the pen will prevent you from turning the black ring so that your dose does not change during your injection.

To release the black ring, press in the green injection button until it stops. Note that liquid will come out of the needle. Then continue to set your dose using the black ring.

Set the new dose by turning the black ring.

Call your doctor or nurse immediately and follow his/her instructions.

Call your doctor or nurse and follow his/her instructions.

The pen can deliver doses from 0.10 mg to 1.5 mg of Genotropin. Each click of the black ring changes the dose by 0.05 mg.